

CHAMBER IS BONDED TO ADAPTOR PLATE

Manway adaptor plate for 1.2m Square chamber base.  
Fits S7 chamber.

For reference purposes only. This drawing is not a specification. Order against product code only. To enable continuous improvement of our products, the designs and specifications are subject to change without notice.

**FIBRELITE**   
PART OF OPW A DOVER COMPANY

MATERIAL STEEL, ZINC PLATED

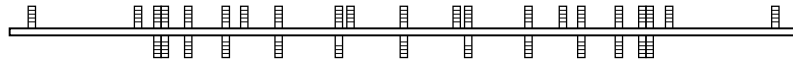

"C" QUANTITY OF M16 x 30 STEEL STUDS  
EQUI-SPACED ON PCD "B"

28 X M10 X 30 Lg  
STEEL STUDS

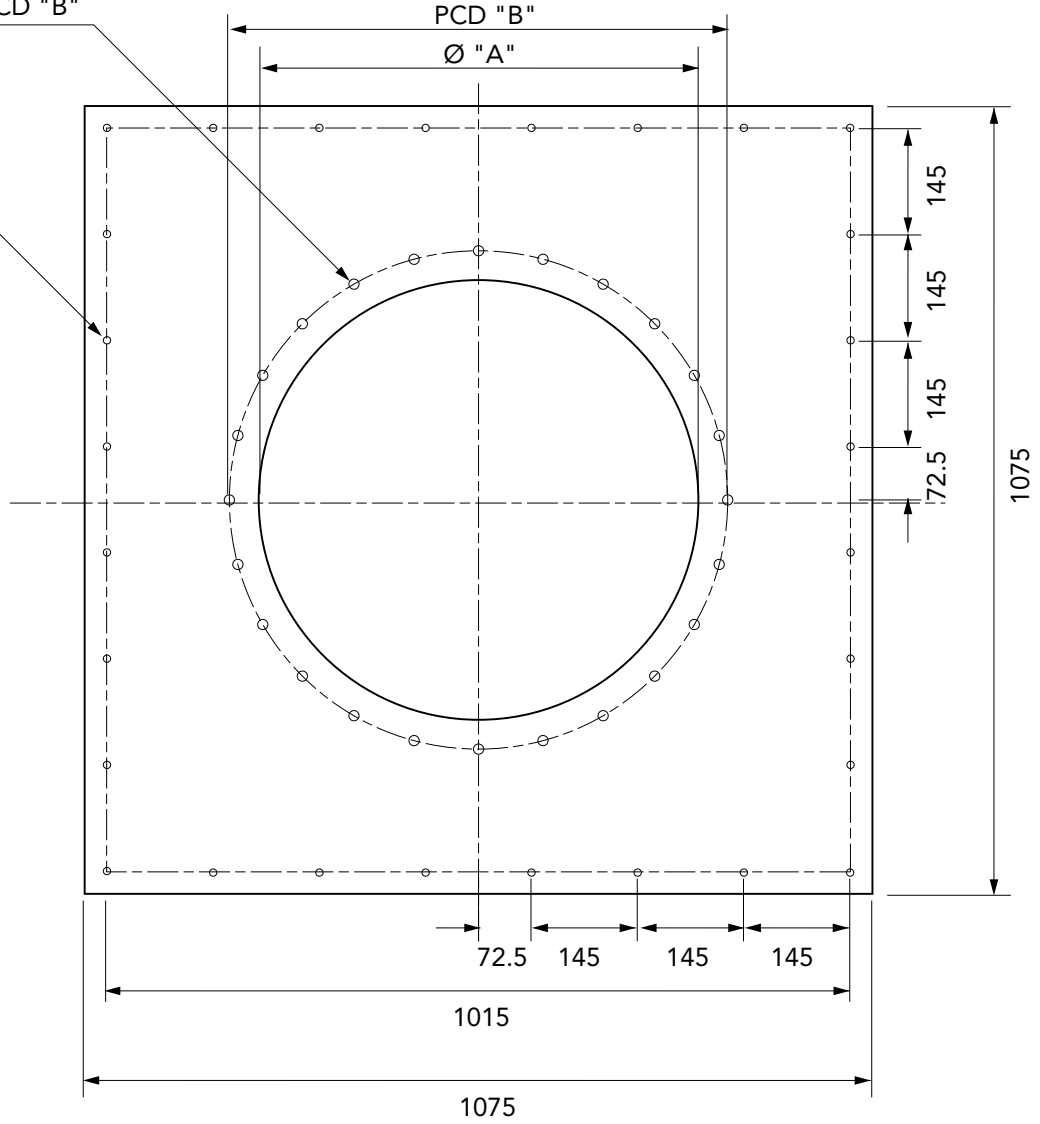

Item	Nominal Size	Dimensions		
		A	B	C
1	460	470	527	20
2	460	470	530	16
3	600	600	680	24
4	600	600	680	28
5	600	600	680	32